

## FLATWALL MOUNTING INSTRUCTIONS:

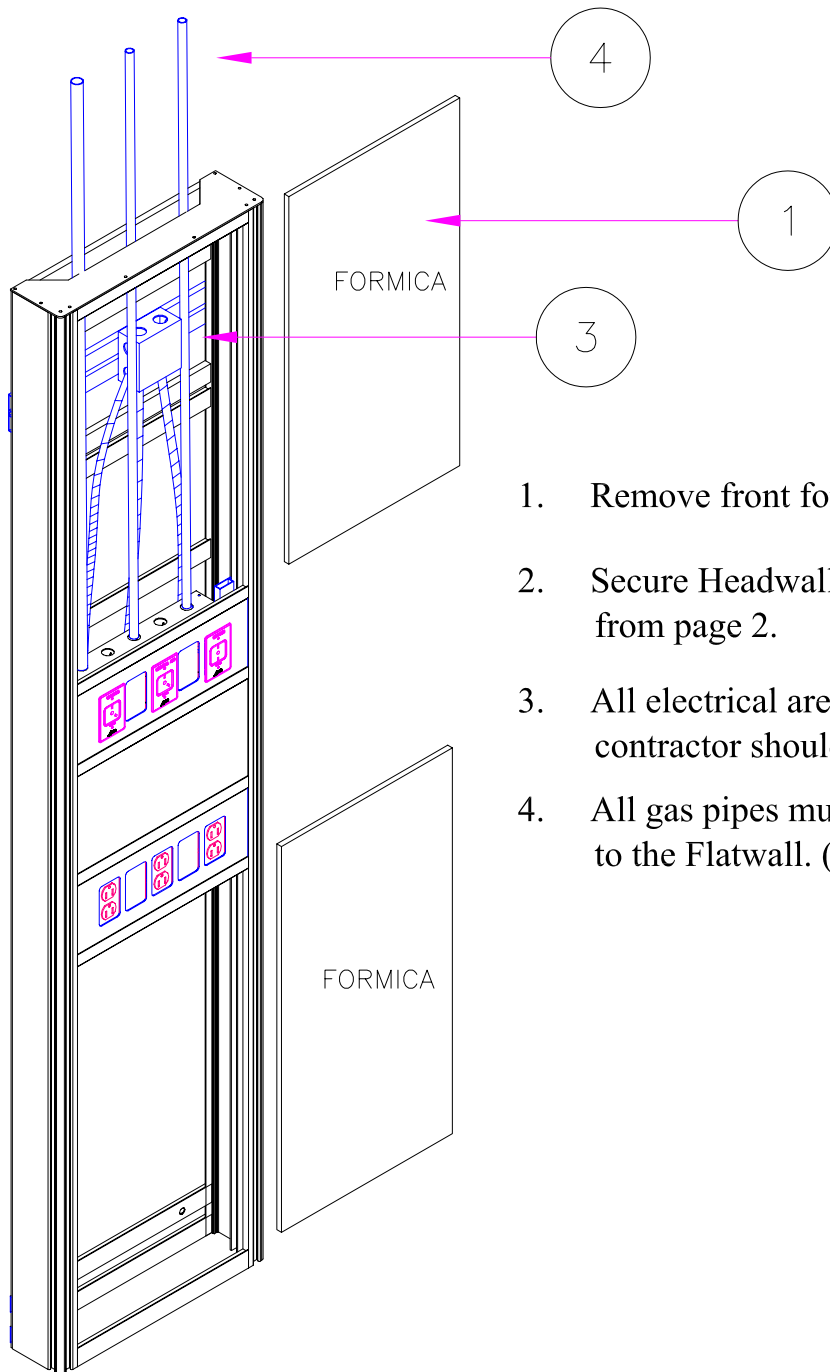

1. Remove front formica panels as shown.
2. Secure Headwall to the wall following instructions from page 2.
3. All electrical are pre-wired to junction boxes and contractor should supply power to junction box.
4. All gas pipes must be rough-in from the ceiling to the Flatwall. (As shown on top)

# FLATWALL MOUNTING INSTRUCTIONS:

WALL MOUNTING BRACKET  
(TO BE SECURED ON THE WALL)  
SEE INSET DRAWING

USE THIS SIDE TO MOUNT  
ON WALL BRACKET

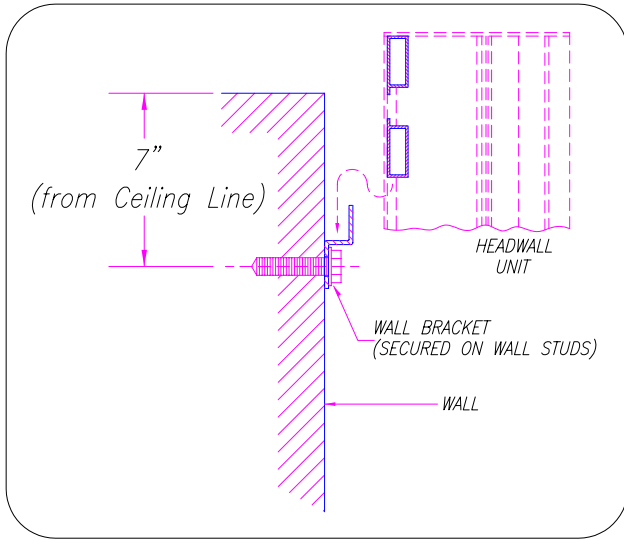

HOLE THRU  
 $\phi 3/8"$   
3 TYP  
(HOLES FOR MOUNTING  
TO WALL)

